





DOUBLE-GLASS MODULE

DYMOND CS6K-270 | 275 | 280P-FG

Canadian Solar's Dymond CS6K-P-FG module is a 60 cell double-glass module with an extended power output warranty. By replacing the traditional polymer backsheets with heat-strengthened glass, the Dymond module has a lower annual power degradation than a traditional module and better protection against the elements, making it more reliable and durable during its lifetime.

KEY FEATURES

-  Up to IEC1500 V_{DC} system voltage, saving on BoS cost
-  Minimizes micro-cracks and prevents snail trails
-  21.5 % more energy generation
-  Fire Class A and Type 3 / Type 13 certified according to IEC 61730-2 / MST 23 and UL 1703
-  5400 Pa snow load, 2400 Pa wind load

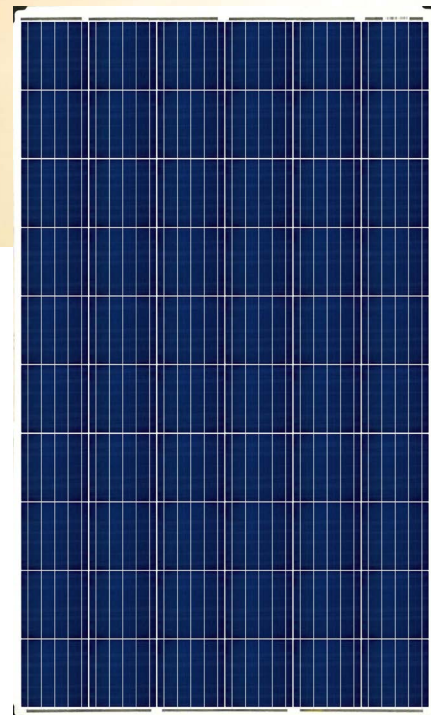

*Transparent double-glass module can be provided upon request.

30
years

power output warranty

10
years

product warranty on materials and workmanship

MANAGEMENT SYSTEM CERTIFICATES*

ISO 9001:2008 / Quality management system

ISO 14001:2004 / Standards for environmental management system

OHSAS 18001:2007 / International standards for occupational health & safety

PRODUCT CERTIFICATES*

IEC 61215 / IEC 61730: VDE / CE / CQC / MCS / CEC AU

UL 1703: CSA / UNI 9177 Reaction to Fire: Class 1

Take-e-way



* If you need specific product certificates, and if module installations are to deviate from our guidance specified in our installation manual, please contact your local Canadian Solar sales and technical representatives.

CANADIAN SOLAR INC. is committed to providing high quality solar products, solar system solutions and services to customers around the world. As a leading PV project developer and manufacturer of solar modules with over 24 GW deployed around the world since 2001, Canadian Solar Inc. is one of the most bankable solar companies worldwide.

CANADIAN SOLAR INC.

545 Speedvale Avenue West, Guelph, Ontario N1K 1E6, Canada, www.canadiansolar.com, support@canadiansolar.com

Rear View

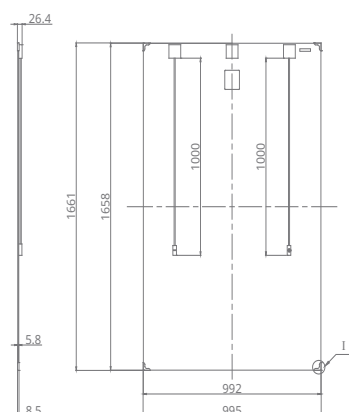

Corner Protector Detail

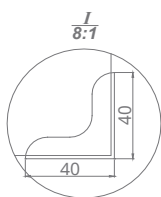

CS6K	270P-FG	275P-FG	280P-FG
Nominal Max. Power (Pmax)	270 W	275 W	280 W
Opt. Operating Voltage (Vmp)	30.8 V	31.0 V	31.3 V
Opt. Operating Current (Imp)	8.75 A	8.88 A	8.95 A
Open Circuit Voltage (Voc)	37.9 V	38.0 V	38.2 V
Short Circuit Current (Isc)	9.32 A	9.45 A	9.52 A
Module Efficiency	16.42%	16.72%	17.02%
Operating Temperature	-40°C ~ +85°C		
Max. System Voltage	1500 V (IEC) or 1000 V (UL)		
Module Fire Performance	Type 3 / Type 13 (UL 1703) or CLASS A (IEC 61730)		
Max. Series Fuse Rating	15 A		
Application Classification	Class A		
Power Tolerance	0 ~ + 5 W		

ELECTRICAL DATA | NMOT*

CS6K	270P-FG	275P-FG	280P-FG
Nominal Max. Power (Pmax)	199 W	202 W	206 W
Opt. Operating Voltage (Vmp)	28.3 V	28.5 V	28.8 V
Opt. Operating Current (Imp)	7.01 A	7.10 A	7.16 A
Open Circuit Voltage (Voc)	35.3 V	35.4 V	35.6 V
Short Circuit Current (Isc)	7.52 A	7.63 A	7.68 A

PERFORMANCE AT LOW IRRADIANCE

* The specifications and key features contained in this datasheet may deviate slightly from our actual products due to the on-going innovation and product enhancement. Canadian Solar Inc. reserves the right to make necessary adjustment to the information described herein at any time without further notice.

Figure 10 consists of two graphs, A and B, showing the dependence of the current A on the voltage V for different temperatures and power densities. The left graph (A) is for 5°C and the right graph (B) is for 25°C . Both graphs show four curves for power densities of 1000 W/m^2 (red), 800 W/m^2 (dark grey), 600 W/m^2 (light grey), and 400 W/m^2 (orange). The current A ranges from 0 to 10, and the voltage V ranges from 0 to 40. The curves show a sharp drop in current as voltage increases beyond a certain point, indicating a transition to a different state.

Specification	Data
Cell Type	Poly-crystalline, 6 inch
Cell Arrangement	60 (6×10)
Dimensions	1658×992×5.8 mm (65.3×39.1×0.23 in) without J-Box and corner protector
(Incl. corner protector)	1661×995×8.5 mm (65.4×39.2×0.33 in) without J-Box
Weight	23 kg (50.7 lbs)
Front / Back Glass	2.5 mm heat strengthened glass
Frame	Frameless
J-Box	Split J-Box, IP67, 3 diodes
Cable	4.0 mm ² (IEC), 12 AWG (UL)
Cable Length	1000 mm (39.4 in), 500 mm (19.7 in) (+) and 350 mm (13.8 in) (-) is optional for portrait installation*
Connectors	T4 series
Per Pallet	33 pieces, 825 kg
Per Container (40' HQ)	858 pieces

TEMPERATURE CHARACTERISTICS

Specification	Data
Temperature Coefficient (Pmax)	-0.40 % / °C
Temperature Coefficient (Voc)	-0.31 % / °C
Temperature Coefficient (Isc)	0.05 % / °C
Nominal Module Operating Temperature (NMOT)	43±2 °C

PARTNER SECTION

CANADIAN SOLAR INC.

545 Speedvale Avenue West, Guelph, Ontario N1K 1E6, Canada, www.canadiansolar.com, support@canadiansolar.com