

LONGI

Hi-MO X6 Artist Ultra Black

LR5-54HTHB

420~435M

223 _{W/m²}



Ultimate Solar Design



Uncompromised Quality



Absolute in Technology



Green Power, Green Life

**Complete System and
Product Certifications**

IEC 61215, IEC 61730, UL 61730

ISO9001:2015: ISO Quality Management System

ISO14001:2015: ISO Environment Management System

ISO45001:2018: Occupational Health and Safety

IEC62941: Guideline for module design qualification and type approval

25

25-year Warranty for
Materials and Processing

25

25-year Warranty for
Extra Linear Power Output



22.3%
MAX MODULE
EFFICIENCY

0~3%
POWER
TOLERANCE

<1.5%
FIRST YEAR
POWER DEGRADATION

0.40%
YEAR 2-30
POWER DEGRADATION

Additional Value

25-Year Power Warranty

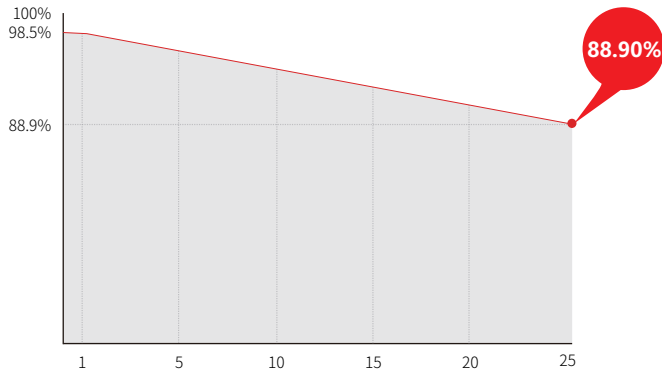

Mechanical Parameters

Cell Orientation	108 (6×18)
Junction Box	IP68
Output Cable	4mm ² , ±1200mm length can be customized
Glass	Single glass, 3.2mm structure glass
Frame	Anodized aluminum alloy frame
Weight	21.0 kg
Dimension	1722×1134×30mm
Packaging	36 pcs per pallet / 216pcs per 20'GP / 936pcs per 40'HC

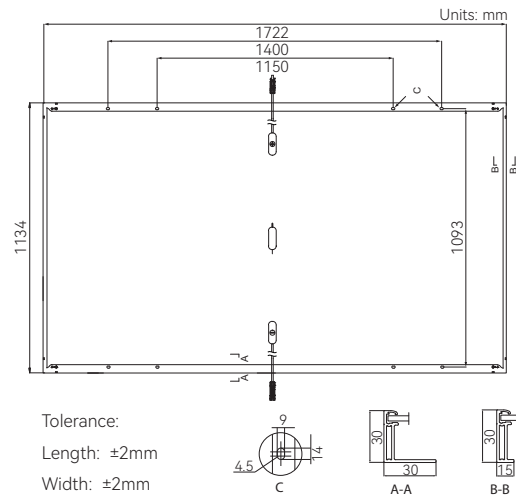

Electrical Characteristics

STC : AM1.5 | 1000W/m² | 25°C

NOCT : AM1.5 | 800W/m² | 20°C | 1m/s

Test uncertainty for Pmax: ±3%

Module Type	LR5-54HTHB-420M		LR5-54HTHB-425M		LR5-54HTHB-430M		LR5-54HTHB-435M	
	STC	NOCT	STC	NOCT	STC	NOCT	STC	NOCT
Maximum Power (Pmax/W)	420.00	313.82	425.00	317.55	430.00	321.29	435.00	325.02
Open Circuit Voltage (Voc/V)	39.15	36.76	39.35	36.95	39.55	37.13	39.75	37.32
Short Circuit Current (Isc/A)	13.64	11.02	13.71	11.07	13.79	11.14	13.88	11.21
Voltage at Maximum Power (Vmp/V)	32.73	29.87	32.93	30.05	33.13	30.23	33.33	30.41
Current at Maximum Power (Imp/A)	12.84	10.52	12.91	10.58	12.98	10.64	13.06	10.70
Module Efficiency(%)	21.5		21.8		22.0		22.3	

Operating Parameters

Operational Temperature	-40°C ~ +85°C
Power Output Tolerance	0 ~ 3%
Maximum System Voltage	DC1500V (IEC)
Maximum Series Fuse Rating	25A
Nominal Operating Cell Temperature	45±2°C
Protection Class	Class II
Fire Rating	IEC Class C

Mechanical Loading

Front Side Maximum Static Loading	5400Pa
Rear Side Maximum Static Loading	2400Pa
Hailstone Test	25mm Hailstone at the speed of 23m/s

Temperature Ratings (STC)

Temperature Coefficient of Isc	+0.050%/°C
Temperature Coefficient of Voc	-0.230%/°C
Temperature Coefficient of Pmax	-0.290%/°C